

20S EVO Quick Start Guide

ENGLISH

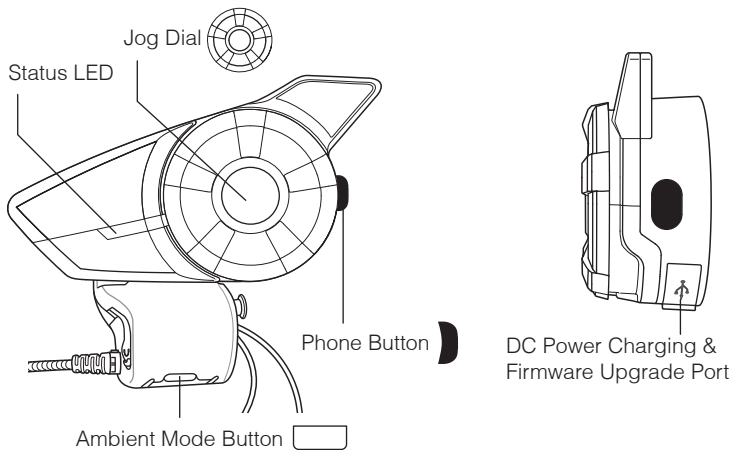

Installation

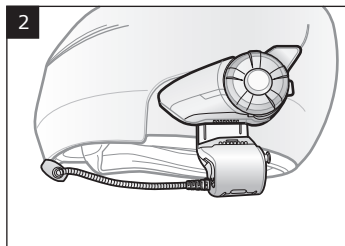
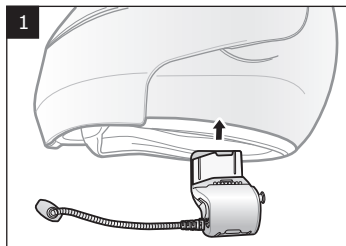

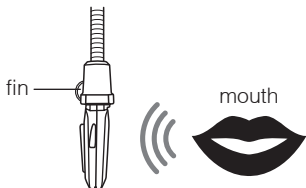
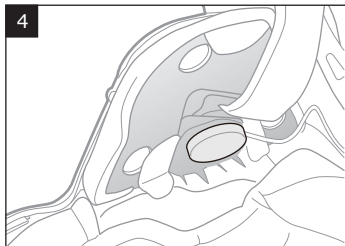
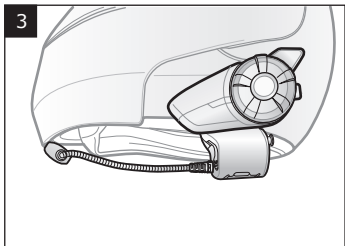

Microphone Direction

Button Operation

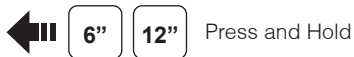

Power On/Off

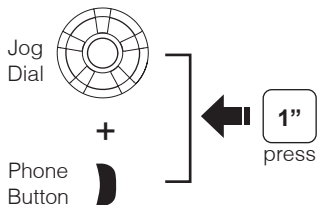

Volume Adjustment

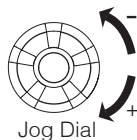

Ambient Mode

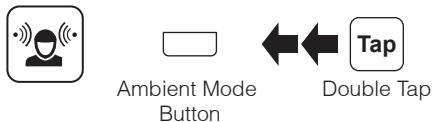

Bluetooth Pairing Phone, MP3 and GPS



Status LED

Select **Sena 20S**

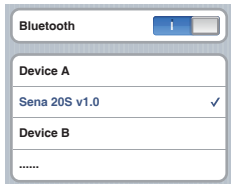

Enter PIN

Mobile Phone



Answer



Phone Button



Tap



End



Phone Button



Tap



Voice Dial



Phone Button



Tap



Speed Dial



Phone Button



Tap

Double Tap



Reject



Jog Dial



2"

press



Call Transfer



Phone Button



2"

press

Music

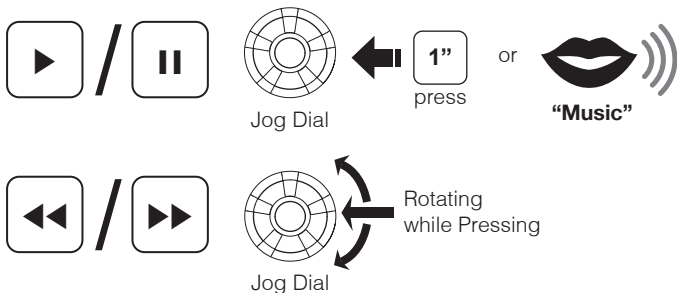

Battery Check

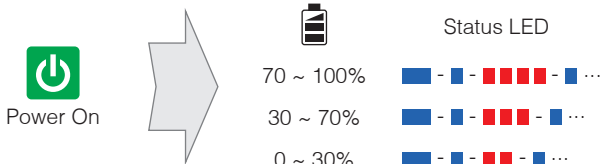

Configuration Menu



There is **Universal Intercom Pairing** in the Configuration Menu.

Normal Pairing Intercom

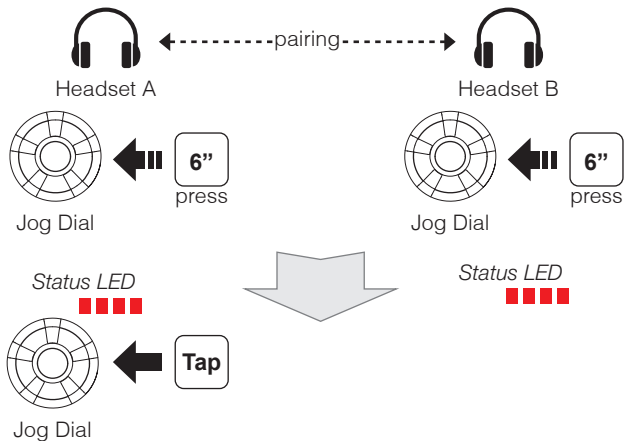

Start / End Intercom

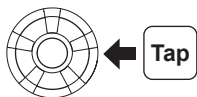

1st Friend

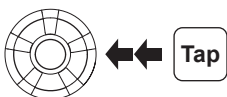

2nd Friend

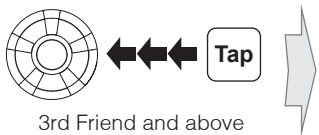

3rd Friend and above

3rd ~ 9th
Friend, Cancel

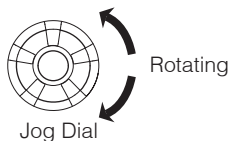

Jog Dial

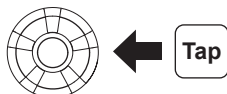

Jog Dial

Start / End Group Intercom



Ambient Mode
Button



press

Radio On / Off



Radio Seek Stations



Radio Scan Up FM Band



Save to preset while scanning



Radio Save or Delete Preset

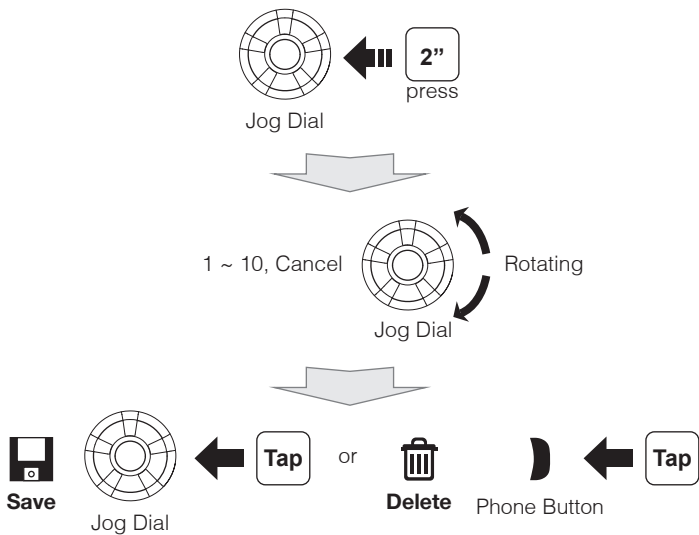

Radio Move to Preset Station

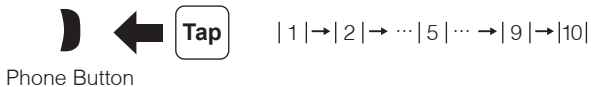

Voice Command

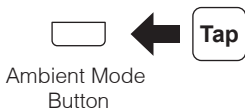

or



Voice Command	Function
“Music”	Music play/pause
“FM radio”	FM Radio on/off
“Intercom [one, two, ... , nine]”	Start/End each intercom
“Speed dial [one, two, three]”	Speed dialing

A full version of the manual is downloadable at
www.sena.com.

SENA



Sena Technologies, Inc.

Customer Support: sena.com